

Start here



Important safety and care instructions

Your Video Baby Monitor 5000 from BT is manufactured to comply with European safety standards. Please read the following instructions carefully before installing and using it.

- Installation and location**
- For indoor use only in UK and Ireland.
 - Position all parts away from heat and sun (e.g. away from radiators, window sill or get hot).
 - Keep area ventilated (e.g. don't put in cupboards or back of sofas) and don't try to open your devices or power section of the user guide.
 - Don't try to open your devices or power adapters. There are no serviceable parts and you risk an electrical shock.
 - This product is designed as just an aid. It isn't a substitute for responsible child care – at least one metre away.
 - Keep device and cables out of young children's reach – at least one metre away.
 - Bed or playpen.
 - Only use power adapters provided by product isn't a substitute for insurance or appropriate measures to safeguard your property.
 - When used to monitor property, this adult supervision.
 - When used to monitor property, this product isn't a substitute for insurance or appropriate measures to safeguard your property.
 - You must have permission and comply with applicable laws if you want to use your camera in places where it may affect devices and power adapters in damp areas.
 - Electronic devices have liquids; don't place liquid on fragile surfaces (e.g. veneered wood or delicate fabrics); place on a mat if required.
 - Designated for use at room temperatures between 0 and 40°C.
 - Don't use near flammable substances or in a flammable atmosphere (e.g. warehouse or garage).
 - This device uses wireless technology; check before using or installing where restrictions may apply such as in hospitals.
- Battery safety information**
- The battery can't be removed or replaced.
 - If you need repairs, get in touch with our helpdesk.
 - Take care when disposing of your product. The battery could explode if placed in a fire, a hot oven or is crushed or cut.
 - Don't subject the product to extremely low air pressure as the battery may explode or leak flammable liquid or gas.
 - To ensure snail parts aren't exposed.
 - Regularly check your product for damage.
 - Rebraid, and don't pull or twist any cables.
 - Treat all parts with care; no shock or vibration, and don't pull or twist any cables.
- Care and maintenance**
- Treat all parts with care; no shock or vibration, and don't pull or twist any cables.
 - Regularly check your product for damage.
 - To ensure snail parts aren't exposed.
 - Don't subject the product to extremely low air pressure as the battery may explode or leak flammable liquid or gas.
 - Chemicals or solvents.
 - cloth for the lens); do not use water.



Getting set up

1. Plug the cable into the parent unit, then plug it into the mains power socket and switch the socket on. Please use power supply unit item code 089010 (BLJ06W050100P1-B).
2. Leave to charge for 12 hours.

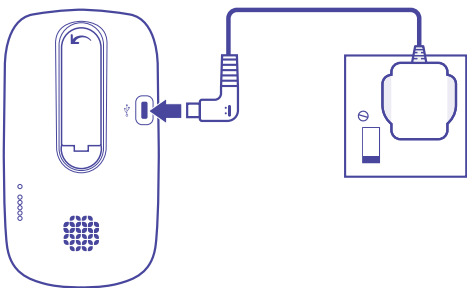

Tip
The first time you use the parent unit, or if you haven't used it for a long time, it'll take 12 hours to fully charge.
We recommend you keep the cable plugged into the battery life on a single charge lasts for 4 hours. The battery gets very low, it'll take about 30 minutes to charge enough for you to use it for a short time. To charge the parent unit in the shortest amount of time, turn it off while it's charging.

3. Place the baby unit near a power socket in the room where you're going to be monitoring your baby most of the time. It should also be at least one metre away from your baby.
4. Plug the cable into the baby unit, then plug it into the mains power socket and switch the socket on. Please use power supply unit item code 089010 (BLJ06W050100P1-B).

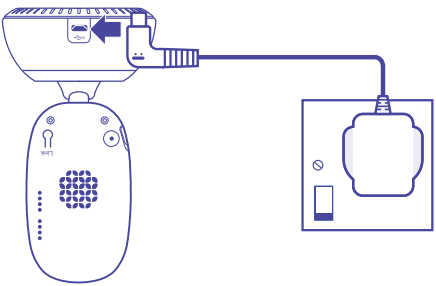

5. Slide the off button on the side of the baby unit up to turn it on.

Tip
Keep the power cord out of baby's reach by looping any extra length and securing it.

6. After the parent unit has charged for 12 hours you can switch it on.

Before you do, move the parent unit at least one metre from the baby unit. Any closer and you might get audio feedback sounds. Press the  button and hold for 2 seconds to turn the parent unit on.

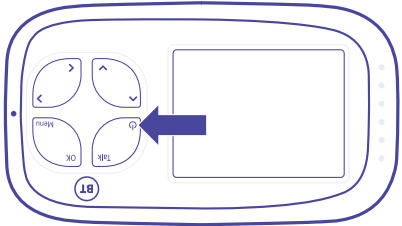

The parent unit and baby unit are automatically linked so they are now ready to use.

What's the range?
The maximum range between your parent and baby units is about 250 metres outdoors and about 50 metres indoors. Thick walls and doors reduce the units' range and affect how they link to each other.

Troubleshooting

Can I add another camera unit to this bundle?

- BT currently does not sell add-on camera units. A brand new bundle will need to be purchased.

My parent unit / baby unit isn't working, what should I do?

- Please ensure the parent unit is fully charged or plugged into the mains.
- Ensure both parent unit and baby unit are switched on.
- Move the parent unit closer to the baby unit and away from large obstructions or other electrical devices as these may affect the signal between the two units.
- Switch the baby unit off, and wait for about 15 seconds and then switch back on again.

Why can I hear a high-pitched noise?

- This is likely to be caused by the units being too close to each other. We recommend they are kept at least 1 metre apart and preferably in different rooms.

Why is my parent unit beeping?

The parent unit only beeps when:

- The baby unit is switched off and there is no connection to the parent unit.
- The units are too far apart, please move them closer (but not closer than one metre).
- The battery on the parent unit is low, please plug into the mains.
- Interference may be causing connection issues, please ensure both devices are moved away from other electrical devices (TV's, Microwaves, mobile phones etc.).

Why is the parent unit not making any sounds even though there's noise from my baby's room?

- Please ensure both units are plugged into the mains or that the parent unit is fully charged.
- The speaker may either be on mute or the volume is too low to hear.
- The parent unit may be out of range of the baby unit, please move closer (but keep at least 1 metre apart to avoid interference). In this scenario the parent unit would beep to inform you of this issue.
- Large metal obstructions and other electrical devices may be impacting the signal. Try relocating both devices if possible.

Other information

Radio transmission information

Frequency range (GHz)	2.415–2.471
Max power (dBm)	17.1

Radio Equipment Directive Declaration of Conformity and Power Efficiency Info

Hereby, British Telecommunications plc declares that the radio equipment type VBM5000 (088305) is in compliance with Directive 2014/53/EU. The full text of the EU declaration of conformity and power efficiency information is available at: bt.com/producthelp

This device has been evaluated for and shown compliant with European Guidelines when installed and operated with a minimum distance of 16mm between the unit and your body.

The item code for both power supply units is 089010 (BLJ06W050100P1-B).

The full text of the EU declaration of conformity is available at the following internet address: bt.com/producthelp

Disposing of your old electrical and electronic equipment

The Government has a legal requirement to minimise the unsorted waste disposal of electrical and electronic equipment and to maximise its separate collection and environmentally sound management. The symbol shown here and on the product, means you shouldn't throw it in your normal rubbish at the end of its working life.



This product may contain substances that could be harmful to people or the environment if it's not recycled correctly. Check with your retailer to find out how to recycle your old equipment, or if you've bought something from us that has the crossed out wheellie bin symbol on it and it's similar to the kit you don't need any more, you can send us your old kit and we'll get rid of it in an environmentally friendly way.

Here's the address: WEEE Take Back Scheme, BT Returns, BT DF, Darlington Road, Northallerton, DL6 7ZY.

Website address: bt.com/weee

We're not responsible for the costs of returning items. If you don't wish to return kit to us, lots of electronics shops have their own 'take back' schemes where you can recycle very small electrical and electronic goods. If you're a household user, you can also take it to your local recycling centre – go to recyclenow.com to find the one nearest to you. Please dispose of this carefully and help to protect our planet.

Guarantee

Your VBM5000 is guaranteed for 2 years from when you bought it. This means we'll either repair it or replace all or part of the product if it's not working properly.

If you bought the product more than 28 days ago, we might replace it with a refurbished or repaired one.

Guarantee conditions

- The guarantee only covers problems found in the 2 year guarantee period.
- You'll need your receipt or other proof of purchase.
- Your product is returned to BT or one of our partners as instructed.
- This guarantee doesn't cover any problems caused by accidents, misuse, fair wear and tear, neglect, tampering with the equipment, or any attempt at adjustment or repair other than through approved agents.
- The guarantee is valid within the UK and Ireland only. You're responsible for the cost of returns to the original retailer or repair agent. If BT needs to provide replacement parts, these can only be despatched to an address within the UK or Ireland.
- This guarantee doesn't affect your statutory rights.

Within the 2 year guarantee period

Before returning your product, please take a look at the Help section beginning on page 1 or contact the Baby Monitor Helpline on 0808 100 6554.

Additional answers to frequently asked questions are available from bt.com/producthelp. If the helpdesk can't fix the problem, they'll let you know how to get a repair or a replacement. If you need to return your product please pack it in the original box if you still have it and make sure you include all the parts such as cables and power supplies. You'll also need a fault reference number from the helpdesk. This does not affect your statutory rights.

Outside of the 2 year guarantee period

If your product needs support after the guarantee period has ended, we recommend that you contact BT's recommended support agent Discount Communications on 0800 980 8999.

To find out what to do if your product is in or outside of the 2 year guarantee, please visit bt.com/producthelp

Using your Video Baby Monitor

In this section you'll find out how to use your baby monitor to make sure you get the best possible use out of it.

To start using your baby monitor, you'll need to turn both units on. You'll see where the Power buttons are located in the diagrams.

The features outlined below are all accessible through the **MENU** which can be opened by pressing the **Menu** button, using the **<** and **>** buttons to navigate, **^** and **v** to scroll through the sub menus and **OK** to select the desired option. To return to the camera feed, simply press the **Menu** button.

Monitoring volume and mute

There are 8 volume settings. The default is 4.

1. In normal monitor mode (**X1**), press **^** or **v** to change the volume.
2. Press **OK** to confirm.
3. To turn the sound off completely, turn the volume down to 0. **🔇** will be displayed on top of the screen.

Screen brightness

There are 8 brightness levels. The default is 4.

1. In normal monitor mode (**X1**), press **<** or **>** to select the brightness level.
2. Press **OK** to confirm.

Lullabies

There are 5 lullabies to choose from or you can play all 5 in sequence.

1. Press **Menu**, **🎵** is displayed, press **OK**.
2. Press **^** or **v** to choose the lullaby 1-5 or press **🎵** to play all five, then press **OK**.
3. Press **^** or **v** to select the volume from 1-3 and press **OK** to save.
4. To stop the lullaby playing, select **🔇**.

Talk to your baby

To give your baby some words of comfort, press and hold down **Talk** on the parent unit and speak into the parent unit's microphone. The **🗣️** icon will be displayed at the bottom right corner. Release the button when you've finished speaking.

Pan/tilt and Zoom in/out

- To enter/exit the pan/tilt mode, press **OK**. When in Pan/tilt mode, press **<**, **>**, **^**, **v** to move the image.
- To enter zoom mode, press **Menu**, then press **>** to display **🔍**, then press **^** or **v** to select the zoom level and press **OK** to exit menu.

Set a reminder

You can set an alert to remind you of something you need to do, for example when your baby's next feed is due. You can set it for 2, 4 or 6 hours.

1. Press **Menu**, then press **v** to display **🕒** and press **OK**.
2. Press **^** or **v** to select the reminder time (**2H**, **4H** or **6H**), then press **OK** to save. The **🕒** will be displayed on the top right of the screen.
3. To cancel the alert, select **🔇**.

Set the screen to turn on and off automatically

You can set the screen to turn on by pressing any button. On this setting, the screen will turn off automatically when no button is pressed during 1, 3 or 5 minutes.

1. Press **Menu**, then press **v** to display **📺** and press **OK**.
2. Press **^** and **v** to select **1**, **3** or **5** minutes and press **OK**.
3. To turn the screen back on at any time, press any button. If you want to set the screen on all the time, set the screen setting **📺** to off **🔇**.

Turn sound activated screen mode on or off

When set to On, the screen will turn on if noise is detected from the baby unit. If it's set to Off, the screen will stay off even if noise is detected. To use this feature, you need to set the standby mode first to 1, 3 or 5 minutes as described above.

1. Press **Menu**, then press **v** to display **🔊** and press **OK**.
2. Press **^** or **v** to select **✓** (for On) or **✗** (for Off) and press **OK**.
3. To turn the screen back on at any time, press the **📺**.

Temperature sensor

The reading from the temperature sensor will be displayed at the top of the parent unit screen.

To change the temperature display from C to F:

1. Press **Menu**, then press **v** to display **🌡️** and press **OK**.
2. Press **^** or **v** to select **°C** or **°F**, then press **OK**.

Night vision

So that you can see your baby at night, the baby unit automatically uses the light from its infrared LED lights to capture images in a dark room. Because of that, it can only show images in black and white. The **🌙** icon will be displayed at the top of the screen.

Other screen icon descriptions

- 📶** Signal strength
- 🔊** Sound on
- 🔇** Mute
- 📺** Baby unit switched on
- 🔋** Battery status (Full battery shown, scrolling when charging)
- 📷** Camera identification number e.g. Camera 1

Get to know your Video Baby Monitor

Find out how your baby monitor works by familiarising yourself with the buttons and lights.

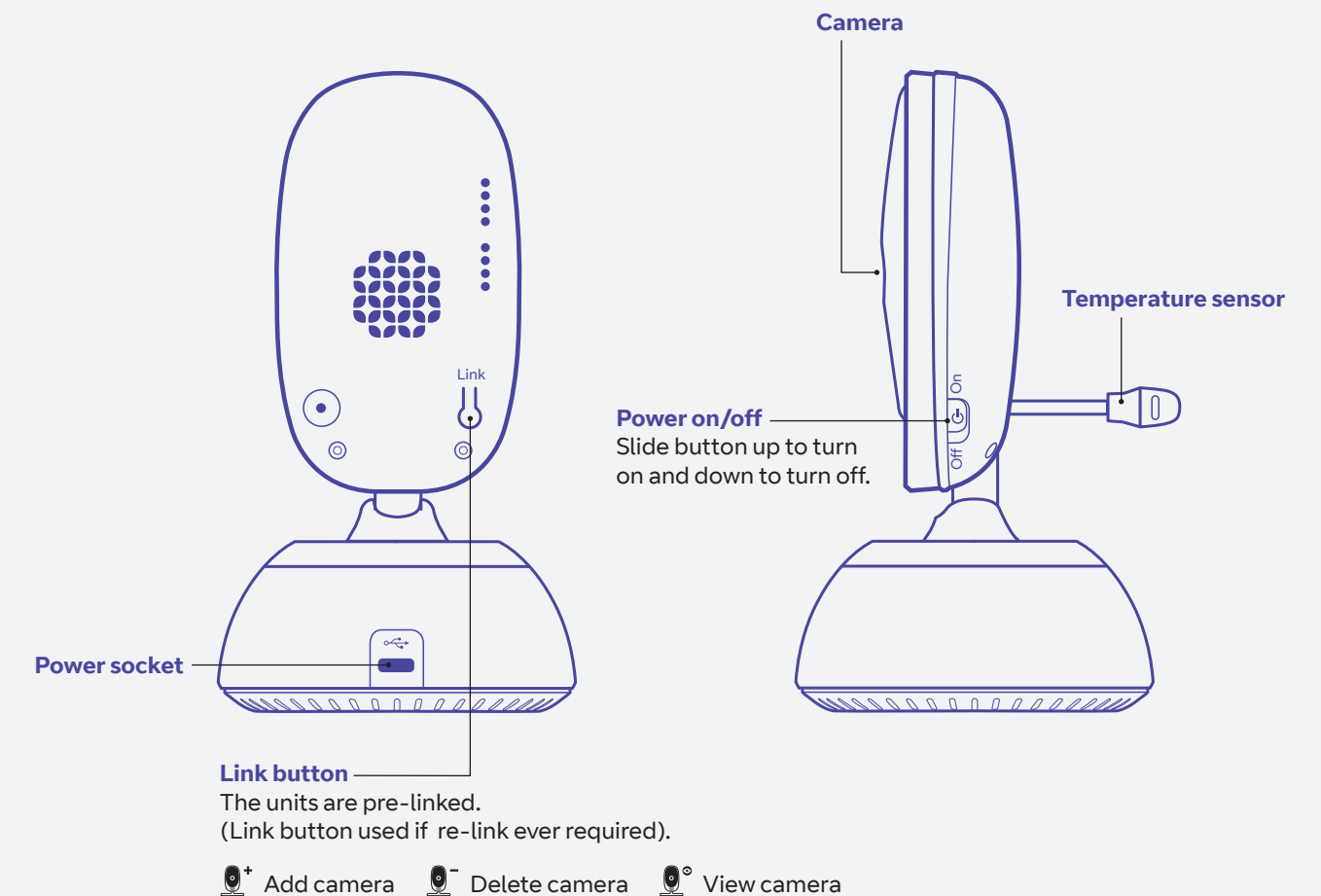

Sound level display

LED lights show the level of sound being detected from the baby unit.

Power on light

Green when parent unit turned on. (Remains green for one minute while charging, after the parent unit is turned off).

Talk

Press and hold to talk to your baby.

OK

Press to select an option in the menu. Press to enter pan and tilt mode, then use the arrows to move the camera.

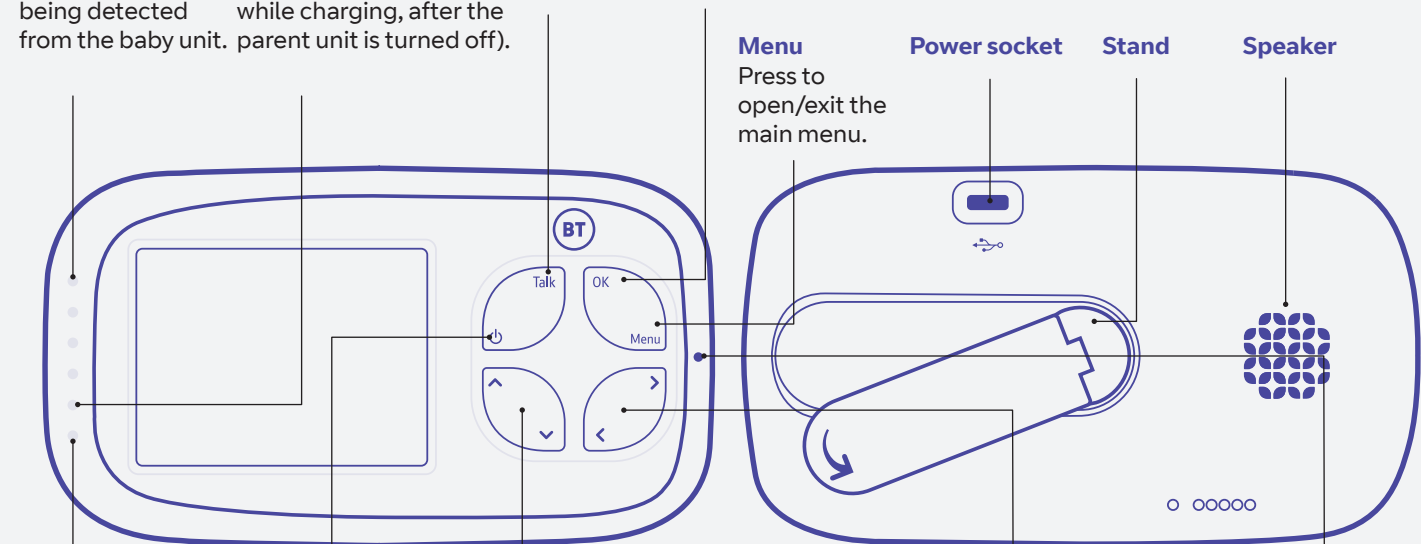

Charging/battery light

Blue when mains power adapter is on, red when battery low.

Power on

Press and hold to turn the unit on and off. Press once to switch to standby mode.

Directional pad (up and down)

Press to scroll up or down when you're in the menu. Press to increase or decrease the speaker volume.

Directional pad (left and right)

Press to move left or right in the menu or to increase or decrease the brightness level.