

- 1 Plug the end of the USB cable into your computer's USB port.
- 2 Your computer will display, 'Your hardware is ready to use,' to indicate that connection is successful.

1 Plug in

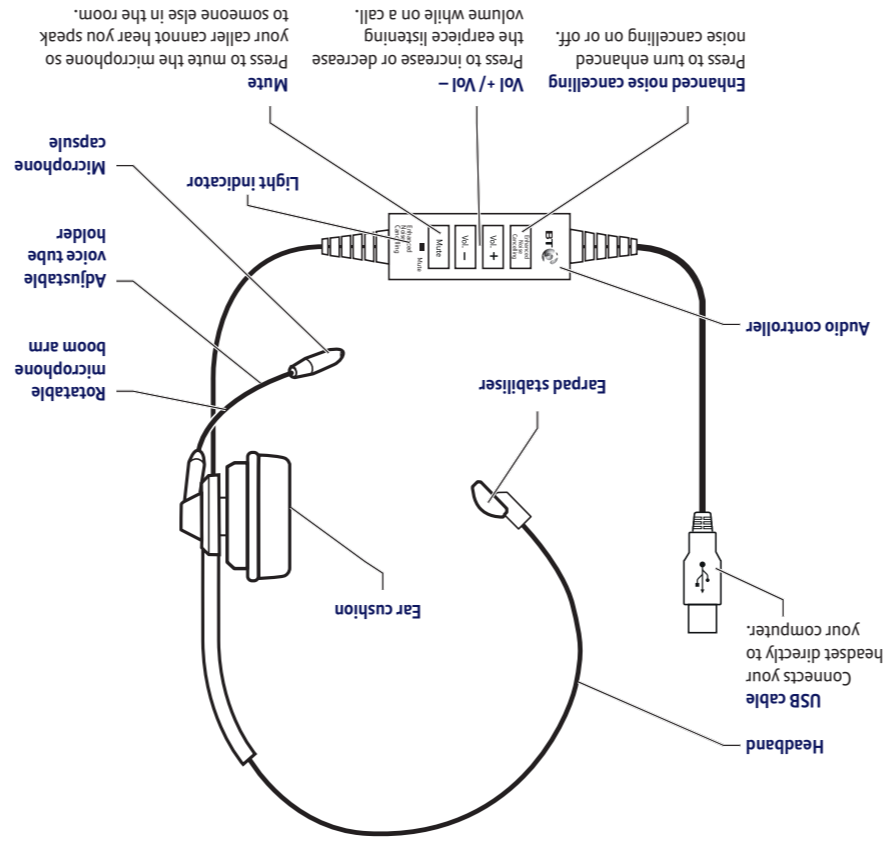

Your headset

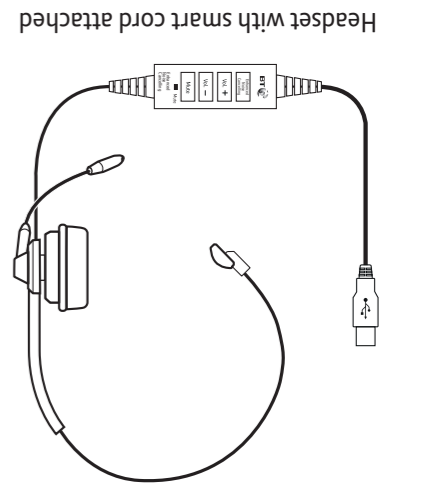

Check box content:

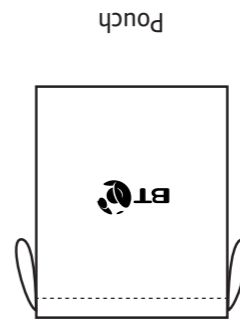

General information

Guarantee

Your BT Corded Headset H32 is guaranteed for a period of 2 years from the date of purchase.

Subject to the terms listed below, the guarantee will provide for the repair of, or at BT's or its agent's discretion the option to replace the BT Corded Headset H32, or any component thereof, which is identified as faulty or below standard, or as a result of inferior workmanship or materials. Products over 28 days old from the date of purchase may be replaced with a refurbished or repaired product.

The conditions of this guarantee are:

- The guarantee shall only apply to defects that occur within the 2 year guarantee period.
- Proof of purchase is required.
- The equipment is returned to BT or its agent as instructed.

This guarantee does not cover any faults or defects caused by accidents, misuse, fair wear and tear, neglect, tampering with the equipment, or any attempt at adjustment or repair other than through approved agents.

This guarantee does not affect your statutory rights.

To find out what to do if your headset is in or outside of the 2 year guarantee, go to bt.com/producthelp

How to recycle your equipment

The symbol shown here and on the product means that the product is classed as electrical or electronic equipment, so DO NOT put it in your normal rubbish bin.

It's all part of the Waste Electrical and Electronic Equipment (WEEE) Directive to recycle products in the best way – to be kinder to the planet, get rid of dangerous things more safely and bury less rubbish in the ground.

You should contact your retailer or supplier for advice on how to dispose of this product in an environmentally friendly way.

R&TTE Directive & Declaration of Conformity

This product is intended for use within the UK for connection to the public telephone network and compatible switchboards.

This equipment complies with the essential requirements for the Radio Equipment and Telecommunications Terminal Equipment Directive (1999/5/EC).

For a copy of the Declaration of Conformity please refer to bt.com/producthelp



For a Better Future

We're always looking to make our products last longer and use less power, so we don't have such a big impact on the environment.

To find out about what we are doing, visit bt.com/betterfuture

Offices worldwide

The services described in this publication are subject to availability and may be modified from time to time. Services and equipment are supplied subject to British Telecommunications plc's respective standard conditions of contract. Nothing in this publication forms any part of a contract.

© British Telecommunications plc 2013. Registered Office: 81, Newgate Street, London EC1A 7AJ. Registered in England No. 1800000.

Designed and produced by The Art & Design Partnership Ltd.

Printed in China / Issue 2 / ADP07-13



User Guide



- 1 Plug in
- 2 Wearing your headset
- 3 Audio settings

BT Corded Headset H32

Setting up is easy. Just follow the simple steps in this guide.

If you'd like further help, please visit our website bt.com/producthelp or call our helpdesk on 0808 100 6996*.

* Calls made from within the UK mainland network are free. Mobile and international call costs may vary.

2 Wearing your headset

Position the headset

Place the headband over the top of your head with the headset positioned against your preferred ear and the earpad stabiliser positioned just above the opposite ear.

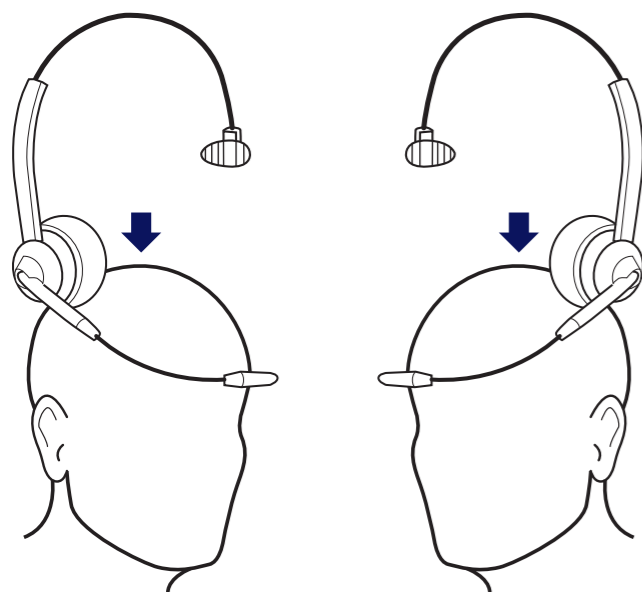

Adjust the headband length

Push up or pull down the top section of the headband until it fits comfortably on your head.

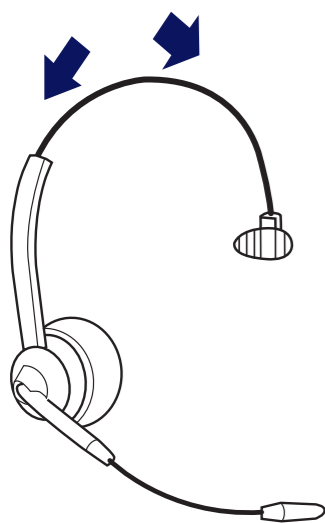

Position the microphone

- 1 Adjust the microphone by rotating the microphone boom as shown, until the microphone capsule is at a comfortable distance from your mouth.
- 2 The voice tube holder can be extended or shortened so you can adjust the distance the microphone capsule is from your mouth.

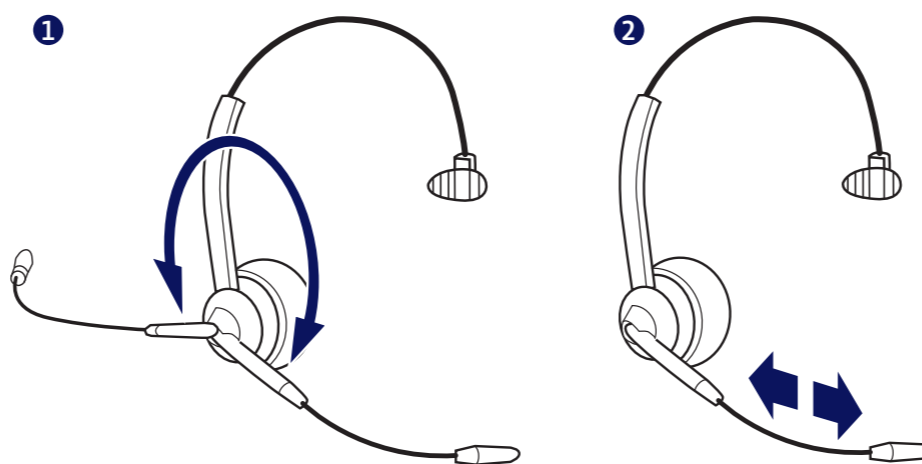

- 3 To achieve the best sound quality, the microphone capsule should be positioned at a comfortable distance from your mouth so your voice is heard clearly by your caller.

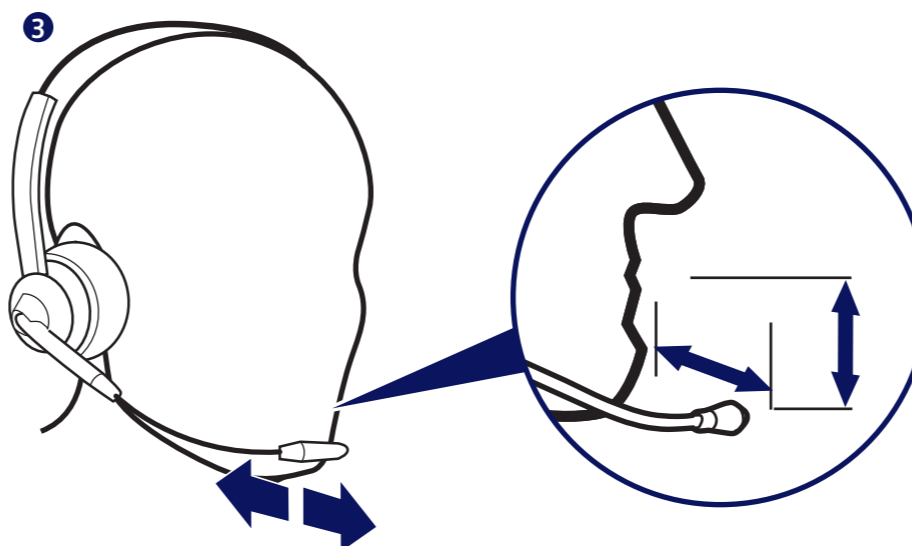

3 Audio settings

Audio controller

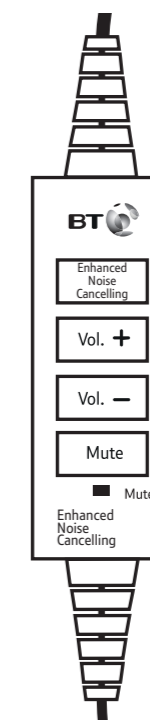

Adjust the earpiece (listening) volume

- 1 During a call, press or to increase or decrease the earpiece listening volume.

Mute

You can turn the headset microphone off so your caller cannot hear you speak but you will still be able to hear your caller.

- 1 During a call, press . The light indicator will glow red to show that Mute is on.
- 2 To turn mute off, press again, the light indicator will turn off.

Enhanced noise cancelling

Designed to be used in particularly noisy environments. When turned on, the additional level of noise cancelling is activated.

- 1 During a call, press . The light indicator will glow blue to show the feature is on.
- 2 To turn off, press again, the light indicator will turn off.

 If you need more help, go to bt.com/producthelp or call 0808 100 6996*.