

Wall mounting (optional)

Your BT Response 75+ is ready to start receiving messages.

Press and hold **Time**. Current day setting is announced. Whist holding down **Time**, use **Skip** and **Skip** to select correct day. When the day setting you want is announced, release **Time** button. Press and hold **Time**. Current hour setting is announced. Whist holding down **Time**, use **Skip** and **Skip** to select correct hour using the 12 hour clock. When the hour setting you want is announced, release **Time** button. Repeat steps 3–4 to set the correct minutes. The full day and time is announced.

Set time and day

General information

For information on safety instructions, cleaning, technical information or connecting to a switchboard, please refer to the 'General Information' section in the full user guide at www.bt.com/producthelp

Guarantee

Your BT Response 75+ is guaranteed for a period of 12 months from the date of purchase.

Subject to the terms listed below, the guarantee will provide for the repair of, or at BT's or its agent's discretion the option to replace the BT Response 75+, or any component thereof, which is identified as faulty or below standard, or as a result of inferior workmanship or materials. Products over 28 days old from the date of purchase may be replaced with a refurbished or repaired product.

The conditions of this guarantee are:

- The guarantee shall only apply to defects that occur within the 12 month guarantee period.
- Proof of purchase is required.
- The equipment is returned to BT or its agent as instructed.

This guarantee does not cover any faults or defects caused by accidents, misuse, fair wear and tear, neglect, tampering with the equipment, or any attempt at adjustment or repair other than through approved agents.

This guarantee does not affect your statutory rights.

For further information within and outside the 12 month guarantee, please refer to the full user guide at www.bt.com/producthelp

Product disposal instructions

The symbol shown here and on the product means that the product is classed as Electrical or Electronic Equipment and should not be disposed with other household or commercial waste at the end of its working life.

The Waste of Electrical and Electronic Equipment (WEEE) Directive (2002/96/EC) has been put in place to recycle products using best available recovery and recycling techniques to minimise the impact on the environment, treat any hazardous substances and avoid the increasing landfill.

Product disposal instructions for residential users

When you have no further use for it, please remove any batteries and dispose of them and the product as per your local authority's recycling processes. For more information please contact your local authority or the retailer where the product was purchased.

Product disposal instructions for business users

Business users should contact their suppliers and check the terms and conditions of the purchase contract and ensure that this product is not mixed with other commercial waste for disposal.

R&TTE Directive & Declaration of Conformity

This product is intended for use within the UK for connection to the public telephone network and compatible switchboards.

This equipment complies with the essential requirements for the Radio Equipment and Telecommunications Terminal Equipment Directive (1999/5/EC).

The Declaration of Conformity is published on the website www.bt.com/producthelp



The display will flash for about 38 seconds and then show (no messages). The display will then flash slowly until any button is pressed.

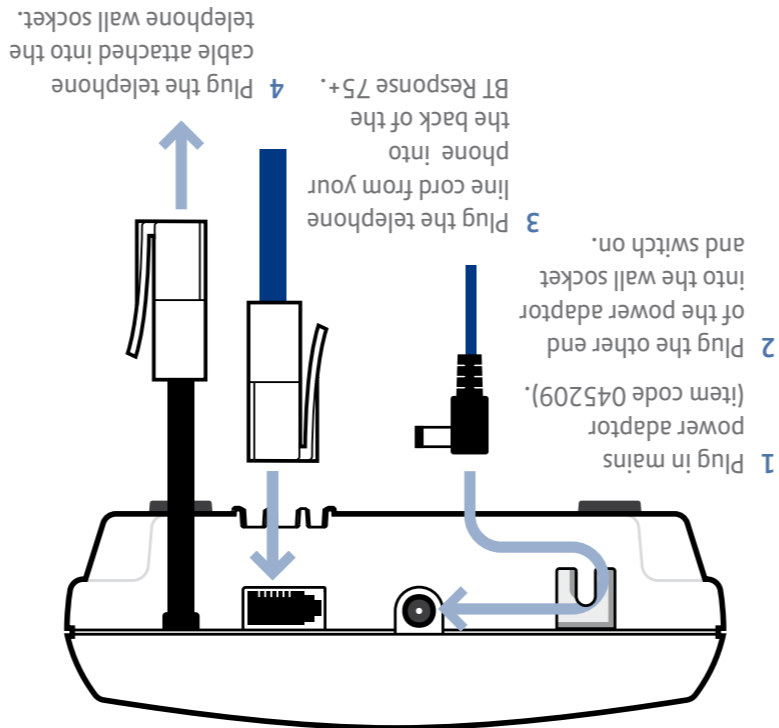

1 Set up

BT & British Gas
Working together, supporting energy saving products
BT & British Gas have joined forces to help our customers find new ways to save energy around the home, so we can all do our bit for the environment & save money too!

BT is a sustainability leader

To find out how we're making our products greener visit

bt.com/betterworld/products

Offices worldwide

The services described in this publication are subject to availability and may be modified from time to time. Services and equipment are supplied subject to British Telecommunications plc's respective standard conditions of contract. Nothing in this publication forms any part of a contract.

© British Telecommunications plc 2008.
Registered Office: 81 Newgate Street, London EC1A 7AJ.
Registered in England No. 1800000.

Designed and produced by The Art & Design Partnership Ltd.

Printed in China / Issue 1 / ADP08-08



BT Response 75+ User Guide



Bringing it all together

- 1 Set up
- 2 Go!



Setting up is easy. Just follow the simple steps in this guide. If you need further assistance, please visit our website www.bt.com/producthelp to view our advanced user guide

Important: Only use the line cord and power adaptor supplied in this box, or this product may not work.

Screws and wall plugs for wall mounting



Mains power adaptor (item code 045209)



Telephone line cord (already attached to answer machine)

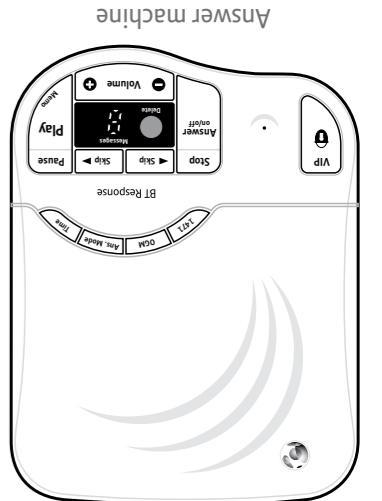
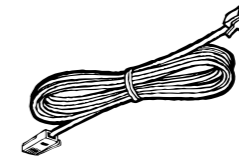

Check box contents

Your answer machine

Answer machine

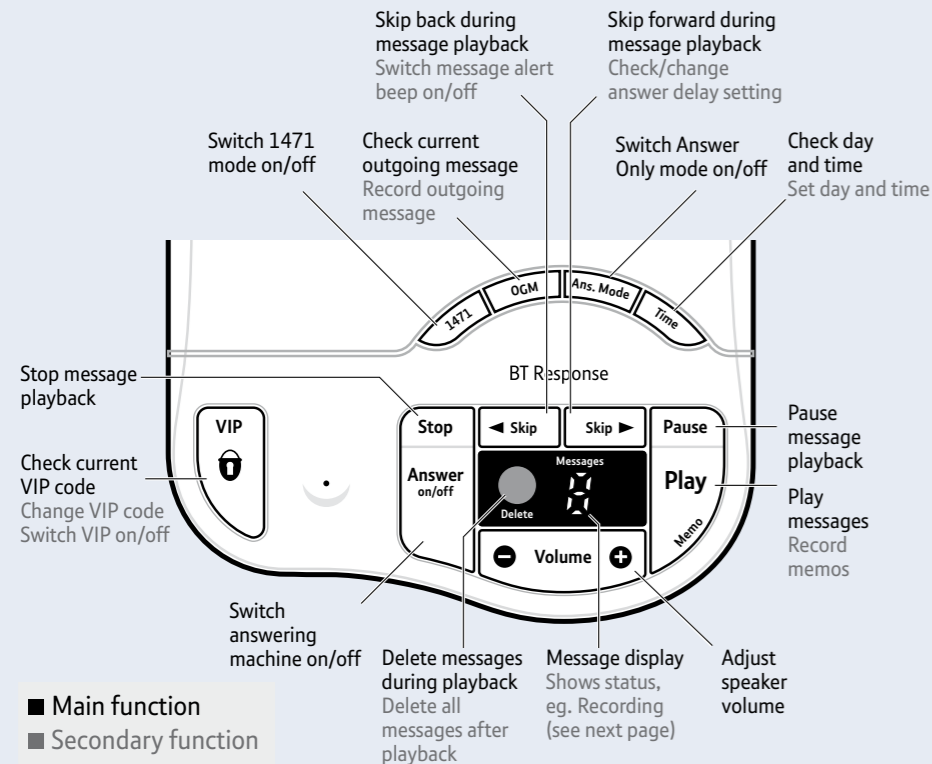

Message display

Message display shows...

| | |
|--|--|
| | Power off |
| | Power up or reset (about 8 seconds) |
| | Answer Off mode |
| | Answer On mode. Number of recorded messages/memos (from 0-9) displayed |
| | Answer On mode. More than 9 messages/memos are recorded |
| | Answer Only mode |
| | Audible message alert ON |
| | Audible message alert OFF |
| | Message paused |
| | Message recording (memo, outgoing message or incoming message) |
| | Remote access in progress |
| | Memory full |
| | Setting or reading Answer delay |
| | 1471 function in progress |
| | Error |

2 Go!

Switch on/off

Press . You will hear, 'Answer on' or 'Answer off'. When off, the message display shows . When on, the display shows the number of recorded messages.

Switch to Answer Only mode

Press . You will hear, 'Answer only on' and the display will show . Your callers will not be able to leave a message now.

Press again to switch Answer Only mode off.

Record your own outgoing message (OGM)

Choose the answer mode you want: press for Answer & Record; press for Answer Only. You can record separate messages for each.

Press and hold . You will hear a beep and the display will show . Keep holding and speak your message clearly about 15-30 cms from the microphone.

Release the button when you've finished. You will hear a long beep and your message will be played back to you.

Check/delete your outgoing message

Select the answer mode you want to check and press .

To delete your OGM and return to one of the pre-recorded messages, press while the message is playing. Playback will stop and you will hear a short beep. The pre-recorded outgoing message will be re-instated.

Set answer delay

Press and keep holding . Current answer delay setting is announced followed by further answer delay options (2-9 rings or time saver). When you hear the setting you want, release . After 2 seconds the new setting will be announced.

Message alert beep on/off

Press and hold to switch between on and off.

Listening to your messages and memos

If the memory becomes full, the display will flash and no further messages can be recorded.

Press . The number of messages will be announced and then played back in the order received. When all messages have been played, you will hear 'End of messages' and the message counter will count down from 8 to 0. During playback, press:

- to adjust speaker volume.
- to pause playback, press again to resume playback.
- to skip to beginning of next message.
- once to return to start of the current message or twice to skip back to previous message.
- to stop playback.
- to mark message for deletion.

To delete all messages, press during the 8 to 0 countdown after message playback. If you press during this countdown, messages marked for deletion will be saved and not deleted.

VIP feature

Sets your answer machine to answer calls silently but allows designated VIP callers to alert you with a beep tone that they are trying to contact you. This feature will only work in Answer on mode. VIP is pre-set to off.

To allow VIP callers to send an alert you will need to tell them the VIP code. **The pre-set code is 40.** When a VIP caller calls you they need to enter the VIP code when they hear your outgoing message. The VIP alert will last for 30 seconds.

If VIP callers wish to cancel the alert, they need to press on their telephone keypad, they can then leave a message after the beep.

To switch VIP on/off

Whilst holding down , press . VIP will be switched on. Repeat the procedure to switch VIP off.

To check the VIP code and setting

Press and release the button. The 2 digit VIP code will be announced and whether the VIP setting is on or off.

To change the VIP code

Press and hold . Keep holding and use and to choose a number between 00 to 59. When you reach the number you want, release and your new code will be announced.

Help

Most problems can be fixed with a few simple checks.

| Problem | Solution |
|---|--|
| No dial tone | Only use the cables supplied. Make sure both the mains power adaptor and telephone line cord are plugged into the correct sockets. |
| No display | Check that the mains power adaptor cable is plugged into the Response 75+ correctly and switched on at the mains power socket. |
| Using broadband on the same phone line? | Make sure you plug the phone into the wall socket via an ADSL microfilter (not supplied), otherwise you may have problems with this product and your broadband service. |
| Messages are not being recorded | Make sure the machine is set to answer on using the button. If is flashing the memory is full, you will need to delete some old messages before any new ones can be recorded. |
| The display is flashing continuously | This indicates an error. Press any button, the flashing should stop and the machine should reset to its setting on first 'power up'. Unplug the line and power cord, wait 5 minutes and then replug. |

Find out more

- New Frequently Asked Questions available at www.bt.com/producthelp
- If you need more detailed instructions, a full user guide is available to download from www.bt.com/producthelp